

# QETTLE®

## LEAK DETECTOR WITH AUTO SHUT-OFF



## INSTALLATION & USER GUIDE

## COMPONENT LIST

1. Auto-Shut Off Valve
2. Leak Detector
3. Leak Detector Cover
4. Label
5. 9V Battery

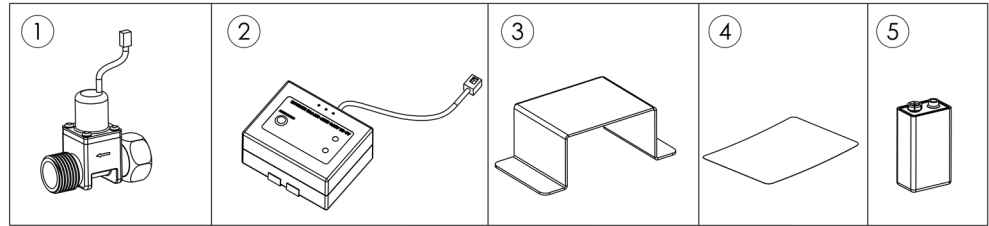

## INTRODUCTION

This guide explains how to install a QETTLE Leak Detector. The guide covers the installation process for installing the Leak Detector in conjunction with a new QETTLE system, or when retrofitting to an existing QETTLE installation. Correctly installed and properly maintained in accordance with the following instructions, it will provide you with many years of reliable service.

Study the diagrams, read this guide and plan the layout carefully before proceeding.

## TECHINCAL DATA

Operating Voltage: 9V DC

Cable Length: 1.5M

Connections: 1/2" BSP Female to 1/2" BSP Male

Minimum Operating Temperature: 20°C

Maximum Operating Temperature: 80°C

Maximum Pressure: 5 BAR (73psi)

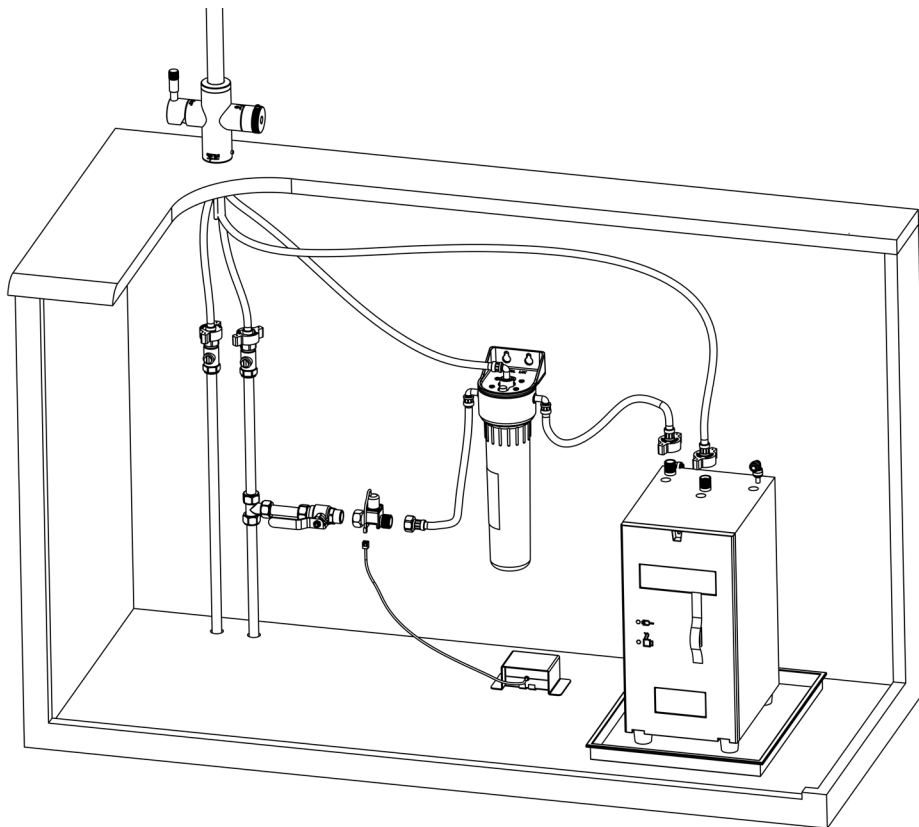

## PLAN THE LOCATION FOR THE LEAK DETECTOR

- **IMPORTANT NOTE:** The leak detector must be positioned on the base of the kitchen cabinet, on a flat surface, with the 2 x metal plates facing down. The 2 x metal plates must be in contact with the base of the cabinet.
- The optimum location for the leak detector is an area between the boiler tank, undersink chiller (if applicable), and the filter housing. The goal with selecting the location is to place the leak detector in the best location to detect leaks from any component of the system.
- Ensure the selected location for the leak detector is within reach (1.5 metres) of the Auto-Shut Off Valve.
- **IMPORTANT NOTE:** Always install the leak detector in conjunction with the mechanical shut-off valve supplied with all QETTLE systems.

## THE INSTALLATION PROCEDURE

The first steps of the installation will vary depending on whether the Leak Detector is being installed as part of a new QETTLE system installation or whether you are retro-fitting it to an existing installation. Please follow the applicable sections outlined below...

### Installation as a Retro-fit

1. Switch off the electricity to your tap's boiler tank by using the switch located on the front of the tank.
2. Run the boiling water until the water runs cold—this will take a good couple of minutes or so.
3. Under the sink, shut off the water supply to your tap's filter unit using the adjacent shut-off valve. Run the filtered cold and filtered boiling water alternately again to de-pressurise the system.
4. Unscrew the inlet hose to the filter housing from the shut-off valve. The hose will contain water, so we recommend having a towel or cloth to hand and a receptacle to catch any residual water.
5. Now follow the remaining steps outlined in the 'Main Installation Process' section **below**.

### Installation with a new QETTLE system

1. You should begin installing the Leak Detector once you have completed the steps outlined in 'THE PLUMBING' section found on page 5 of the QETTLE system installation guide. Once you have got to that stage please follow the remaining steps outlined in the 'Main Installation Process' section **below**.

### MAIN INSTALLATION PROCESS

- Screw the Auto-Shut off valve (1) on to the mechanical shut-off valve supplied with the QETTLE system sufficient to make a watertight seal. **IMPORTANT NOTE** Do not overtighten.
- Screw the filtered water inlet hose on to the Auto-Shut off valve sufficient to make a watertight seal. **IMPORTANT NOTE** Do not overtighten.
- Plug the cable from the Leak Detector (2) into the port on the cable attached to the Auto-Shut off valve (1).
- Place the leak detector cover (3) into position. The cover should be positioned with the opening easily accessible to allow for easy removal of the leak detector. (**IMPORTANT NOTE** if you placing the leak detector on to a cabinet with a metal base you must stick the Sticker (4) provided on to the metal base first. The Sticker prevents a circuit being made and the Auto-Shut off from triggering when the Auto-Shut is placed in position) Remove the backing on the Velcro pads and firmly push the cover into position.
- Install the 9V Battery (5) into the leak detector. Remove the cover on the side of the leak detector and install the battery. Once the battery is installed the leak detector will beep and both the lights on the front of will turn on for 3 seconds.
- Press and hold the reset button on the front of the leak detector for 5 seconds. The leak detector will beep and the blue light on the front will turn on for 3 seconds. The leak detector is now active.
- Place the leak detector in position underneath the cover. Be careful not to accidentally activate the leak detector when sliding underneath the cover when the base of the cabinet is metal.
- Turn the water supply back on to the system using the mechanical shut off valve and check for leaks.
- Turn the power back on to the boiler. The system is now ready for use.

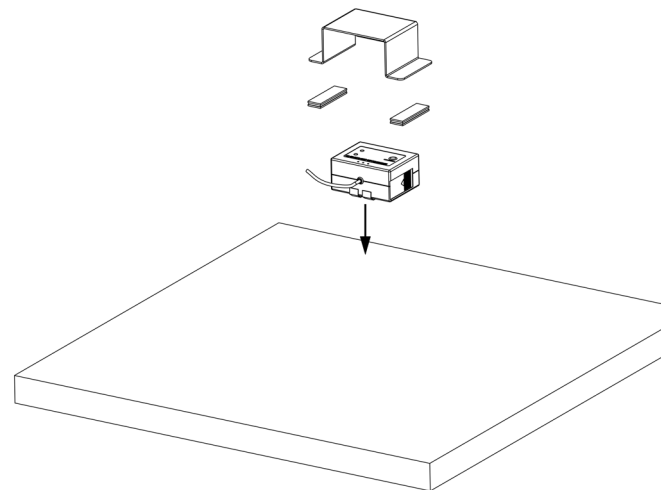

**IMPORTANT NOTE:** use the sticker provided when installing the leak detector on a Metal Cabinet Protector.

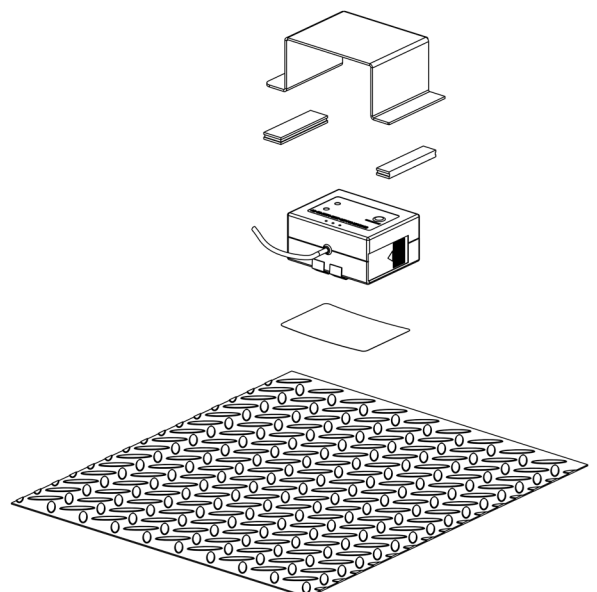

## CARE AND MAINTENANCE

### Resetting the Leak Detector

To reset the Leak Detector and turn the flow of water back on, press and hold the Reset button on the front of the Leak Detector for 5 seconds. The Leak Detector will beep and the blue light on the front will turn on for 3 seconds. After this water should begin flowing through the system again.

### Low Power Warning

The Leak Detector will continuously beep and the Battery light on the front will flash red when the power in the battery is getting low. You should immediately change the battery to ensure that the Leak Detector continues to function. Failure to replace the battery will eventually result in the Leak Detector shutting off the water to the system.

### Changing the Battery

To change the battery remove the Leak Detector from underneath the cover and remove the cover on the side of the leak detector. Remove the old 9V Battery and replace with a new one. Once the new battery is installed the leak detector will beep and both the lights on the front will turn on for 3 seconds.

## GUARANTEE

This Qettle product carries a 1-year guarantee against material and manufacturing defects.

You should also retain your dated invoice as proof of purchase to validate any claims under our guarantee. The guarantee will be valid from the date of purchase as shown on the sales invoice. This appliance is intended for domestic use only. The guarantee does not apply to products installed outside a domestic environment.

### WHAT IS COVERED BY THE QETTLE GUARANTEE?

The repair or replacement of all or part of the unit if the unit is found to be defective due to faulty materials or manufacture within the relevant guarantee periods at Qettle's discretion.

If any part is no longer available, or out of manufacture, Qettle reserve the right to replace it with a suitable alternative.

### TERMS AND CONDITIONS OF THE QETTLE 1 YEAR GUARANTEE

The guarantee is valid for the UK.

The guarantee becomes effective at the date of purchase or at the date of delivery if this is later.

Proof of purchase is required under the terms of the guarantee.

The guarantee provides benefits in addition to your statutory consumer rights.

Qettle  
Old Winery Business Park  
Chapel Street  
Cawston, Norfolk  
NR10 4FE

Phone: +44 (0)1603 875 464  
Email: support@qettle.com

Part No: 999593

### QETTLE DOES NOT GUARANTEE THE REPAIR OR REPLACEMENT OF A PRODUCT THAT HAS FAILED FOR ANY OF THE FOLLOWING REASONS:

- Faulty installation, repairs or alterations not in accordance with the installation guide.
- Normal wear and tear.
- Accidental damage or faults caused by negligent use or care; misuse; neglect; careless operation and failure to use the system in accordance with the Qettle operating guidelines.
- The use of anything other than genuine Qettle replacement parts.
- Failures of, or failures caused by, parts not supplied as part of the genuine Qettle system.

### HOW DO I MAKE A CLAIM UNDER MY GUARANTEE?

If you are in doubt about what is covered by your guarantee, or wish to discuss a claim, please call please call Qettle on 01603 875 464 Monday to Friday between the hours of 9.00am and 5.00pm.

If you are calling for the first time please have your receipt to hand so that we can record your date of purchase.

The company reserves the right to alter, change or modify product specifications without prior notice.

Qettle is a trading name of Greg Rowe Limited